

Rock and sorting grapples

For all excavators between 3,300–72,700 lbs (1,5–33 metric ton)



engcon's rock & sorting grapples in the SG series are suitable for everything from sorting and light demolition work, to where a powerful grapple is needed. Used in combination with the engcon tiltrotator, the grabs excel in tight space material handling, and they also come with the EC-Oil automatic oil connection system as standard equipment.*

The advantages of SG grapples

- » The EC-Oil automatic quick connection system connects the hydraulics without the operator having to leave the cab.*
- » The grapple's claws are fitted with a reversible cutting edge.
- » A load valve and pressure accumulator maintain gripping force for extended periods and for better handling.
- » Engineered to meet and exceed safety standards.
- » Expander bushings in major joints.
- » Bolt-on bracket / top hitch makes switching brackets easy.

Accessories:

- » Tooth kit for better grip.
- » Closed sides to convert the grab into a clamshell bucket.

*Applies to grabs with S45–S80 quick hitch top brackets.



With teeth (accessory)

With closed sides (accessory)

Specifications

Model	SG03	SG06	SG09	SG12	SG19	SG26	SG33
Max grab width A: (inch)	29.5	43.7	53.7	65.4	70.5	78.3	101.4
Min grab width A: (inch)	0	0	0	0	0	0	0
Cutting width B: (inch)	15.7	19.9	24.7	28.1	33.9	33.9	46.1
Jaw length C: (inch)	19.3	18.1	21.2	26.8	31.1	34.3	46.5
Height D: (inch)	21.7	22.8	29.4	31.1	37.8	42.1	53.5
Gripping force: (lbf)	1,281	1,956	3,147	3,372	4,271	5,620	10,116
Max hydraulic pressure: (psi)	3,200	3,200	3,200	3,200	3,200	3,200	3,200
Weight: (lbs)*	240	395	591	935	1,425	1,665	3,086
Volume, with side plates: (gal)	11.1	21.9	36.2	58.1	88.8	111.0	245.7
Grab area: (inch ²)	186	263	372	527	651	806	1317
Base machine weight: (lbs)	3,300 –6,600	6,600 –13,230	13,200 –19,800	22,000 –26,400	26,400 –35,200	35,200 –48,500	48,500 –72,700
Recommended tiltrotator/rotator:	EC02	EC204 EC206	EC206 EC209	EC209 EC214	EC214 EC219	EC219 EC226	EC226 EC233

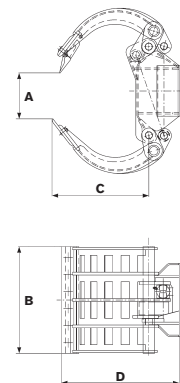

The EC-Oil automatic Quick Coupler system is a free standard on all engcon's hydraulic tools with S40–S80 attachment points.

*Depending on attachment

CHANGE THE WORLD OF DIGGING

engcon Canada Inc | 3220 Av. Jacques-Bureau, Laval QC H7P 0A9
E-mail canada@engcon.com | Web engcon.com