

Integrated grabber

Integrated grabber for EC214 and EC219 *

The new GR20R2 integrated grabber is specially developed for the tough environments that grabs are exposed to on the railway, where a grab will often be used to pull and lift heavy rails with excavators.

Advantages:

- » Robust construction designed for demanding, heavy-duty use e.g. in railroad work.
- » Angled down up to 42 degrees
- » Big grab width – 32.3 inches
- » Protected cylinders

* Standard coupler combinations: S45, S60 and SMP2. Not compatible: S1 and S2. Other coupler combinations on request.

Specifications

Model	GR20R2
Largest grip width A (inches):	32.3
Width B (inches):	15
Length C (inches):	Depending on coupler
Weight (lbs)*:	308
Grab force at 3,046 psi (lbs):	3,850
Angled at 35-42° depending on the bracket	
Detachable	
Protected cylinders	

Note! The GR20R2 cannot be combined with all quick couplers on the market. Contact engcon for further information.

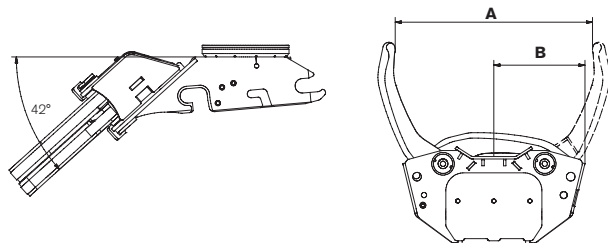

CHANGE THE WORLD OF DIGGING

engcon Canada Inc | 3220 Av. Jacques-Bureau, Laval QC H7P 0A9

E-mail canada@engcon.com | Web engcon.com