

Stone and sorting grab

For all excavators in the 1.5–33 tonne weight classes



Engcon's stone & sieve grabs in the SG series are suitable for everything from sorting to light demolition works where a powerful grab is needed. Used in combination with Engcon's tiltrotators, the grabs provide the access you need, and they also come with EC-Oil automatic oil connection system as standard equipment.*

The advantages of SG grabs

- » The EC-Oil automatic quick connection system connects the hydraulics without the operator having to leave the cab.
- » The grab's claws are fitted with reversible wear bars.
- » A load valve and pressure accumulator maintain gripping force for extended periods and for better handling.
- » Complies with European safety standards.
- » Expander bushings in major joints.
- » Bolt-on bracket/attachment point makes switching brackets easy.



Accessories:

- » Tooth kit for better grip.
- » Closed sides to convert the grab into a grab bucket.

*Applies to grabs with S40–S80 top brackets.

With teeth (accessory)



With closed sides (accessory)

The EC-Oil automatic quick hitch system is a free standard on all engcon's hydraulic tools with S40–S80 attachment.

Specifications

| Model | SG03 | SG06 | SG09 | SG12 | SG19 | SG26 | SG33 |
|---------------------------------|-------|----------------|----------------|----------------|----------------|----------------|----------------|
| Grab width A: (max. mm) | 750 | 1,110 | 1,365 | 1,660 | 1,790 | 1,990 | 2,575 |
| Grab width A: (min. mm) | 0 | 0 | 0 | 0 | 0 | 0 | 0 |
| Cutting width B: (mm) | 400 | 505 | 628 | 715 | 860 | 860 | 1,170 |
| Jaw length C: (mm) | 490 | 460 | 539 | 680 | 790 | 870 | 1,180 |
| Height D: (mm) | 550 | 580 | 748 | 790 | 960 | 1,070 | 1,360 |
| Gripping force: (kN) | 5.7 | 8.7 | 14 | 15 | 19 | 25 | 45 |
| Max hydraulic pressure: (MPa) | 22 | 22 | 22 | 22 | 22 | 22 | 22 |
| Weight: (kg)* | 108 | 180 | 268 | 425 | 646 | 755 | 1,400 |
| Volume, with side plates: (l) | 42 | 83 | 137 | 220 | 336 | 420 | 930 |
| Grab area: (m ²) | 0.12 | 0.17 | 0.24 | 0.34 | 0.42 | 0.52 | 0.85 |
| Recommended machine weight: (t) | 1.5–3 | 3–6 | 6–9 | 10–12 | 12–19 | 18–26 | 24–33 |
| Recommended tiltrotator: | EC02 | EC204 EC206 | EC206 EC209 | EC209 EC214 | EC214 EC219 | EC219 EC226 | EC226 EC233 |

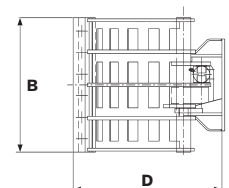
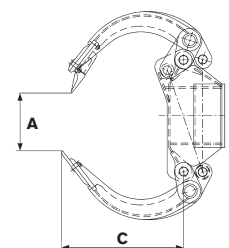

*Depending on attachment

CHANGE THE WORLD OF DIGGING